

REVISIONS			
REV.	DESCRIPTION	DATE	APPROVED
-	NEW RELEASE	-	-
1	MOUNTING BRACKET WAS FABRICATED NOW PURCHASED. REPLACED COMPRESSION PLATE WITH 2 PLATE WASHERS.	4/23/2026	F. BRYANT

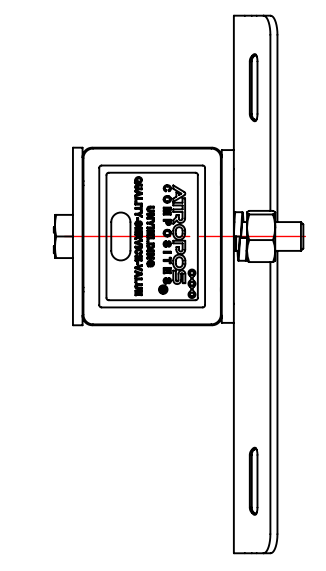

ITEM NO.	PART NUMBER	DESCRIPTION	QTY.
① 1	A700-0042	CROSSARM MOUNTING BRACKET, TANGENT, 3400 SERIES	1
2	3402A120-T011-X903 CA	ASSEMBLY, 3401, CROSSARM, TANGENT, 10 FT, AMERMEN	1
3	A616-0020-02	BOLT, HEX, 3/4"-10 X 6.00" LONG, HOT DIPPED GALVANIZED STEEL, 1-1/8" DRIVE	2
4	A616-0042-01	LOCK WASHER, FOR 3/4" SCREW, 0.766" ID, 1.265" OD, 0.188" THICK, HOT-DIPPED GALVANIZED STEEL	2
5	A616-0019-02	EXTREME STRENGTH NUT, HEX, 3/4"-10, 2H, HOT-DIPPED GALVANIZED	2
① 6	A700-0047	WASHER, SQUARE, 4.625" X 4.625" X 0.25 THICK WITH 0.81 THRU HOLE	2

GENERAL NOTES		UNLESS OTHERWISE SPECIFIED		NAME	DATE
DIMENSIONS ARE IN INCHES STANDARD TOLERANCES		DRAWN: F. BRYANT 10/13/2025		CHECKED: TJS	10/21/2025
FRACTIONAL: ±1/32		ANGULAR: MACHINED: ±0.5° BEND: ±2°		MFG APPR.	
TWO PLACE DECIMAL: ±0.03		THREE PLACE DECIMAL: ±0.005		Q.A.	
INTERFERENCE GEOMETRIC TOLERANCING PER ANSI Y14.5		MATERIAL		PROPRIETARY AND CONFIDENTIAL	
FINISH		THE INFORMATION CONTAINED IN THIS DRAWING IS THE SOLE PROPERTY OF VETLUR. ANY REPRODUCTION IN PART OR AS A WHOLE WITHOUT THE WRITTEN PERMISSION OF VETLUR IS PROHIBITED.		SCALE: 1:8	
DO NOT SCALE DRAWING		TITLE: ASSEMBLY, TANGENT, 3402, (6) WIRE, 10 FT.		SIZE DWG. NO. REV	
		12208 MISSOURI BOTTOM ROAD, HAZELWOOD, MO 63042 PHONE: 314.714.4001 FAX: 314.895.1943 SALES@LABYRINTH-TECH.COM		D 3402A120-T011-X903 1	
		SCALE: 1:8		WEIGHT: 57.26 SHEET 1 OF 1	

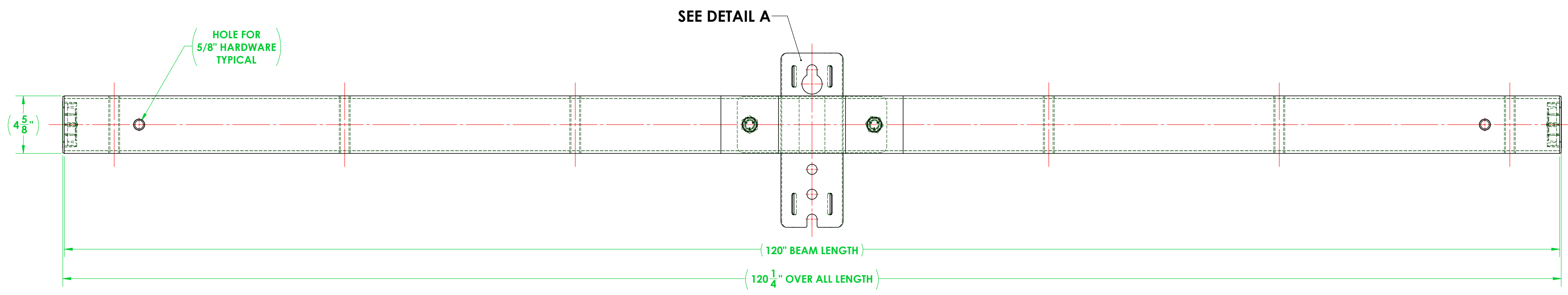
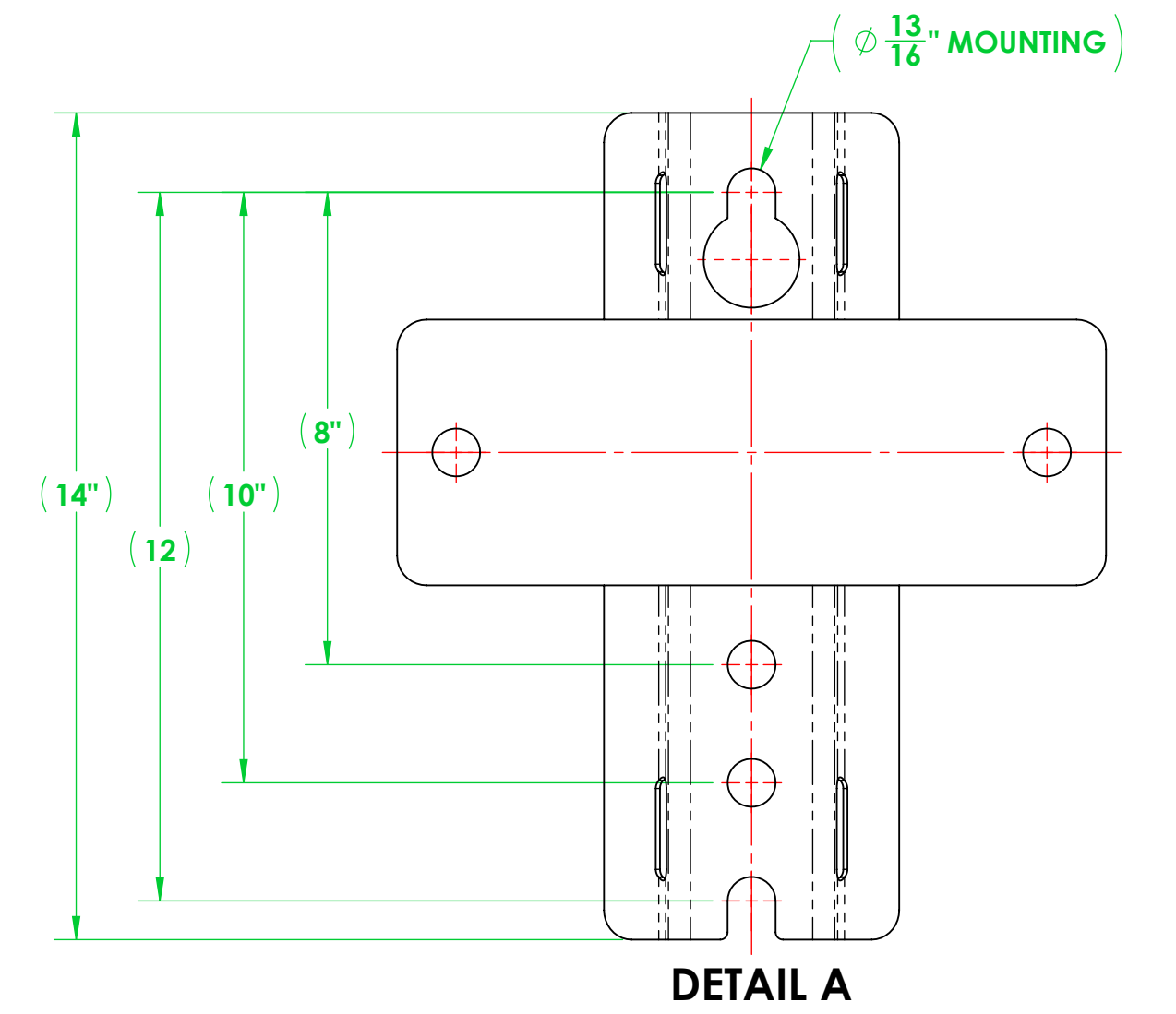
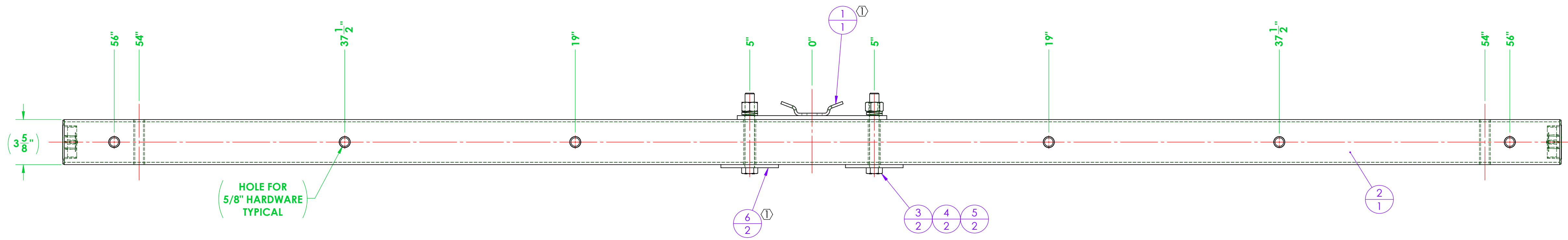